

YONGNUO

## 85F1.85 DF DSM MEDIUM TELEPHOTO PRIME LENS

### USER MANUAL for S

#### Thank you for purchasing YONGNUO product!

Before using the product, please read the instruction manual carefully to ensure that you use the product properly. Please keep the manual properly for future reference.

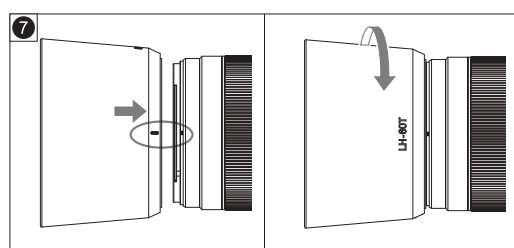
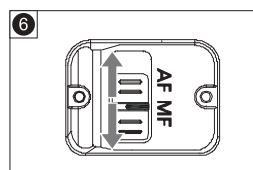
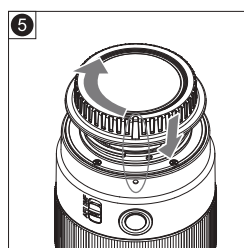
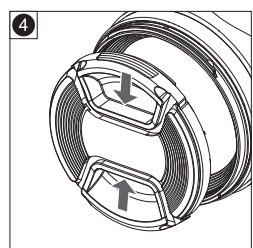
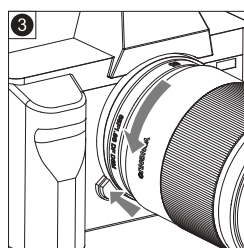
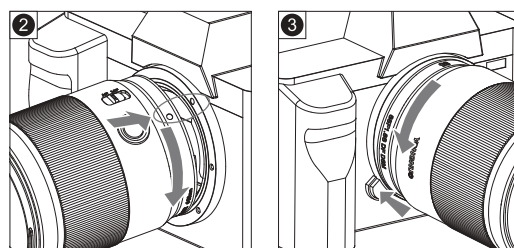
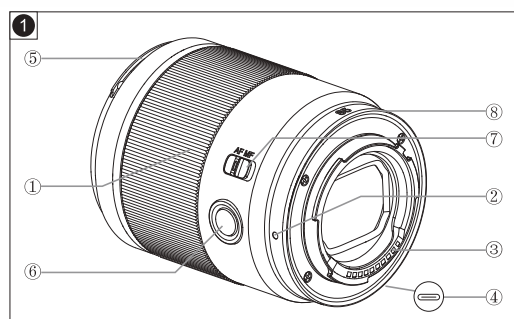

#### Safety Precautions

- \* Please do not look at the sun or bright light source through the lens or camera, otherwise it might cause visual impairment.
- \* Whether the lens is mounted on the camera or not, please do not place the lens under the sun without lens cap covered, otherwise the lens might gather light and cause a fire. Please cover the lens with lens cap when not in use.
- \* Please keep the lens out of reach from children.
- \* Please do not disassemble or modify this product.

#### Nomenclature①

- ①Manual focus ring
- ②Lens mounting mark
- ③Electronic contact
- ④USB interface
- ⑤Lens hood mounting mark
- ⑥Fn Multi-function button
- ⑦Focus mode button
- ⑧Rubber ring

#### Mounting and Detaching the Lens

For details on mounting and detaching the lens, please refer to your camera's user manual.

##### Mounting the Lens ②

Please align the white mounting mark on the lens with the same mounting mark on the camera, then rotate the lens clockwise until 'click' is heard.

##### Detaching the Lens ③

Press the lens release button on the camera, rotate the lens anticlockwise until stop, then detach the lens.

- \* After detaching the lens, please place the lens with the rear end up to prevent lens and electronic contact from getting scratched. If the electronic contact get dirty or contaminated with fingerprints, please clean them with soft cloth.
- \* When detaching the lens, please cover it with dust cap. Please mount the dust cap properly: align the mounting mark on the dust cap with the same mounting mark on the lens, then rotate clockwise. If you need to detach the lens cap, rotate it anticlockwise.

#### Focus Mode ④

The lens supports auto focus and manual focus. To set the focusing mode on the lens: slide the focusing mode switch to the corresponding position. To set the focusing mode on the camera, please refer to the camera manual.

**For AF photography:** both the camera and lens should be set to AF.

**For MF photography:** either or both the camera or lens should be set to MF.

- \* If the lens is not mounted on the camera or the camera is switched off, the focus cannot be adjusted.

#### Fn Multi-function button

Through the camera "focus hold button" custom settings, you can freely assign the required functions for Fn button. Reasonable allocation of Fn button can quickly call up a function menu or execute a shortcut operation, so as to reduce the time of searching the camera menu and improve the creative efficiency.

- \* Focus hold button function settings need to be supported by the camera, please refer to the camera manual for details.

#### Lens Hood

Mounting lens hood can protect lens and block scattered rays which might cause stray light or ghosting.

**Mounting:** Align the mounting mark on the lens hood with the mounting mark on the front lens, then rotate the lens hood clockwise until stop. ⑦

**Detaching:** Rotate the lens hood anticlockwise until stop, then take down the hood.

- \* The hood can be reverse-mounted on the lens for storage.
- \* If the lens hood is mounted improperly, part of the picture may be blocked.
- \* When using built-in-flash or on-camera flash, it is suggested to take out the hood so as not to block the flash light.

#### Filters(Sold Separately)

You can attach a filter in 58mm diameter to the filter mounting thread on the front of the lens.

- \* Only one filter can be attached each time.

#### Firmware Upgrade

This product supports firmware upgrade, please visit website <https://www.hkyongnuo.com/xzyzc> to download the latest upgrade software and firmware. Before use, we suggest you upgrade the lens to the latest firmware for the best user experience.

Upgrade method: Take the lens off the camera, connect the lens with the computer via the USB Type-C cord, start the upgrade software and complete the upgrade operations according to the software prompts.

#### Maintenance and Storage Precautions

- \* Please avoid collision or placing the lens directly in extremely hot, cold and humid environment.
- \* For long storage, please choose a cool, dry and well-ventilated place. Please keep away from pest control pills or places where the pest control pills give off gas, to protect the lens coating.
- \* For cleaning the dirt or fingerprint, you can use soft and slightly wet lens cleaning cloth or lens paper, please do not use solvents, benzene or other organic cleaners.
- \* Please be careful when it rains or being placed near water source, please do not get it wet, if the inner parts, lens or electronic parts get damaged by damp, it may be unable to repair.
- \* Temperature jump may result in condensation of mist and water-beads, therefore, when you get in a warm indoor environment in cold weather, you had better put the lens in sealed plastic bag to wait until the lens temperature is close to room temperature. Please do the same when the lens is taken from warm to cold environment.

#### Troubleshooting

##### 1. In manual focus, the image quality is adjusted to the clearest, but the image is still blurry.

Please check if there are fingerprints or dirt on the front and rear lens, if so, please use soft and slightly wet lens cloth or lens paper to wipe up.

##### 2. AF does not work properly.

Please make sure that both the camera and lens are set to AF.

##### 3. Communication Error When Lens is Mounted on Camera

Please make sure the lens is mounted properly; please check if the lens contacts and camera contacts are soiled or scratched, if it is soiled, please use soft cloth to wipe up, if it is scratched, please return for repair.

##### 4. Other Problems

Please try turning off the camera and taking out the camera battery, then put back the battery, try rebooting the camera. If problems still exist, please contact YONGNUO after-sale service center at 400-001-3888 or email to [service@hkyongnuo.com](mailto:service@hkyongnuo.com) for enquiry.

#### Specification

Focal Length		85mm
Angle of view	Diagonal	28.83°
	Vertical	16.5°
	Horizontal	24.12°
Lens Mount		E Mount
Lens Frame		Full Frame
Lens Construction		9 elements in 8 groups
Aperture Blades		7
Minimum Aperture		F/16
Minimum Focusing Distance		0.8m
Maximum Magnification		0.13x
Driving System		Digital stepper motor
Filter Diameter		58mm
Max. Diameter x Length		About φ67×87mm
Weight		About 385g

- The lens length refers to the distance from the mounting side to the lens front end.
- Unless special stated, the dimension and weight is only suitable for lens. The Aperture can be specified by the camera.

The electronic edition of this user manual can be acquired from <https://www.hkyongnuo.com/xzyzc>.

The function and data listed in this manual are acquired according to YONGNUO testing conditions. The design and specification are subject to change without notice.