

Vivitar®

Illustrated Parts List

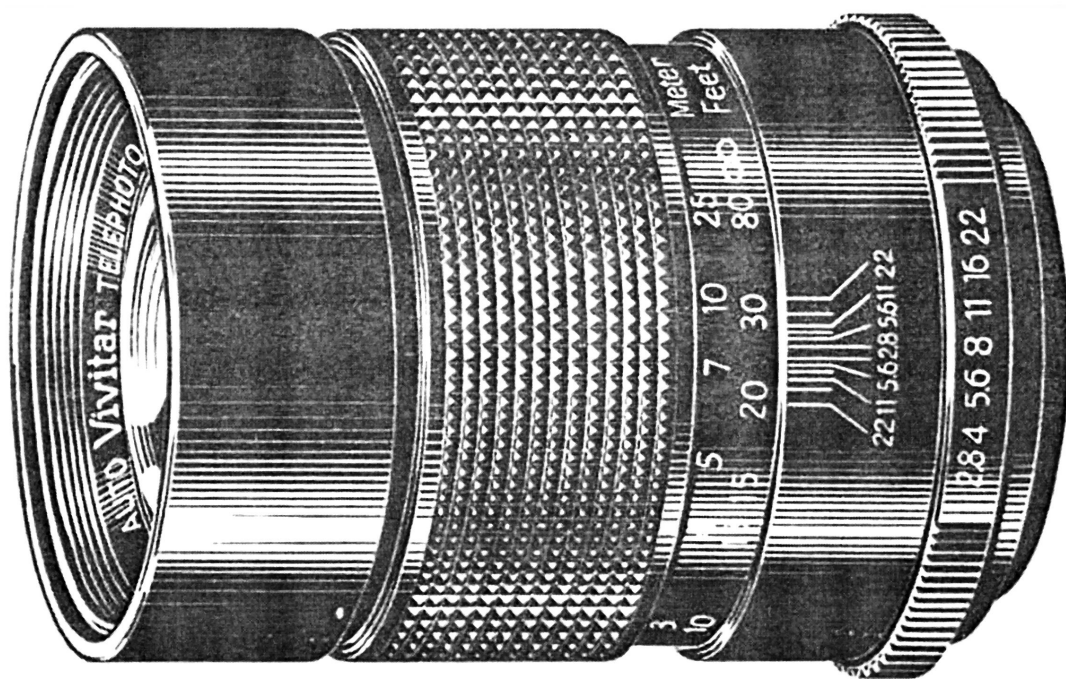

Automatic Fixed Mount Lens
135mm f/2.8

Publication No. **3746042A**

HOW TO USE THIS PUBLICATION

I. CAUTIONS

This publication is intended for use by persons having the skills and equipment needed to service the subject product(s) safely and correctly. Users are cautioned that special tools and/or test equipment may be required for proper disassembly, reassembly, alignment or adjustment of the product.

SPECIAL CAUTION FOR ELECTRICAL PRODUCTS

If the product herein described is electrically operated, its servicing will require extreme caution. Improper handling could result in serious or fatal personal injury or damage to the product.

II. HOW TO FIND PART ORDER NUMBERS

Parts are illustrated on "exploded" drawings where each part is identified by a reference number (having three digits or fewer) or a designator. These reference numbers appear in numerical order in the parts lists (designators appear alphabetically), where they are cross-referenced to part order numbers and descriptions.

When the initials N.A.S. appear in the "Part Number" column, that part is Not Available Separately, and can be obtained only by ordering the assembly containing it. The part number of that assembly may be shown immediately to the right on the same line, in an "Included in Assembly" column, or at the end of the parts list(s).

In parts lists for optical products, quantities of each item are listed as used in the different mounts. The mounts are referred as:

U	= Vivitar-Universal Thread Mount	C	= Canon FL Series Mount
N	= Nikon F, Nikkormat Series Mount	C/FD	= Canon FL/FD Series Mount
M	= Minolta SRT/SR Series Mount	K	= Konica Autoreflex Series Mount
		O	= Olympus OM Series Mount

Note that some parts are common to more than one mount. This commonality is shown in the parts lists so that service centers desiring to stock replacement parts can order economically.

III. HOW TO ORDER PARTS

Please furnish the model number and serial number of the product for which parts are being ordered. For each part requested, please supply part order number, description, and required quantity.

Mail or phone parts orders to:

**Vivitar Central Parts Service
2700 Pennsylvania Avenue
Santa Monica, California 90406**

**Telephone: (213) 829-3672
or (213) 870-0181**

PARTS MANUAL
VIVITAR AUTOMATIC FIXED MOUNT LENS
135MM F/2.8

GENERAL SPECIFICATIONS

Optical Construction	5 elements in 5 groups
Angle of Acceptance	18°
Aperture Range	f2.8 to f22
Minimum Focusing Distance from Film Plane	4½ feet (1.4M)
Weight	15 ounces (425g)
Length at ∞	3¼ inches (82mm)
Maximum Barrel Diameter	2½ inches (62mm)
Accessory Size	55mm
Slip-on Lens Cap Size	60mm
Built-in Lens Hood	

Product specifications are subject to change without notice.

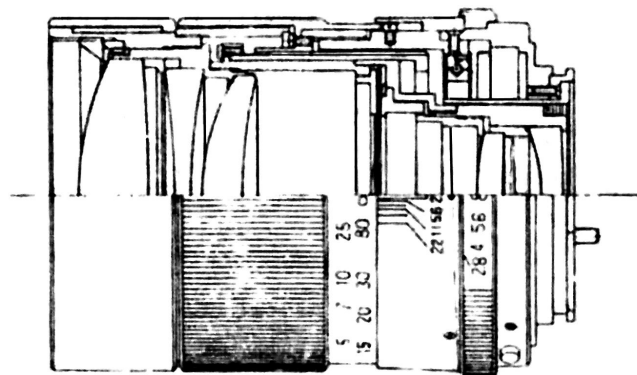

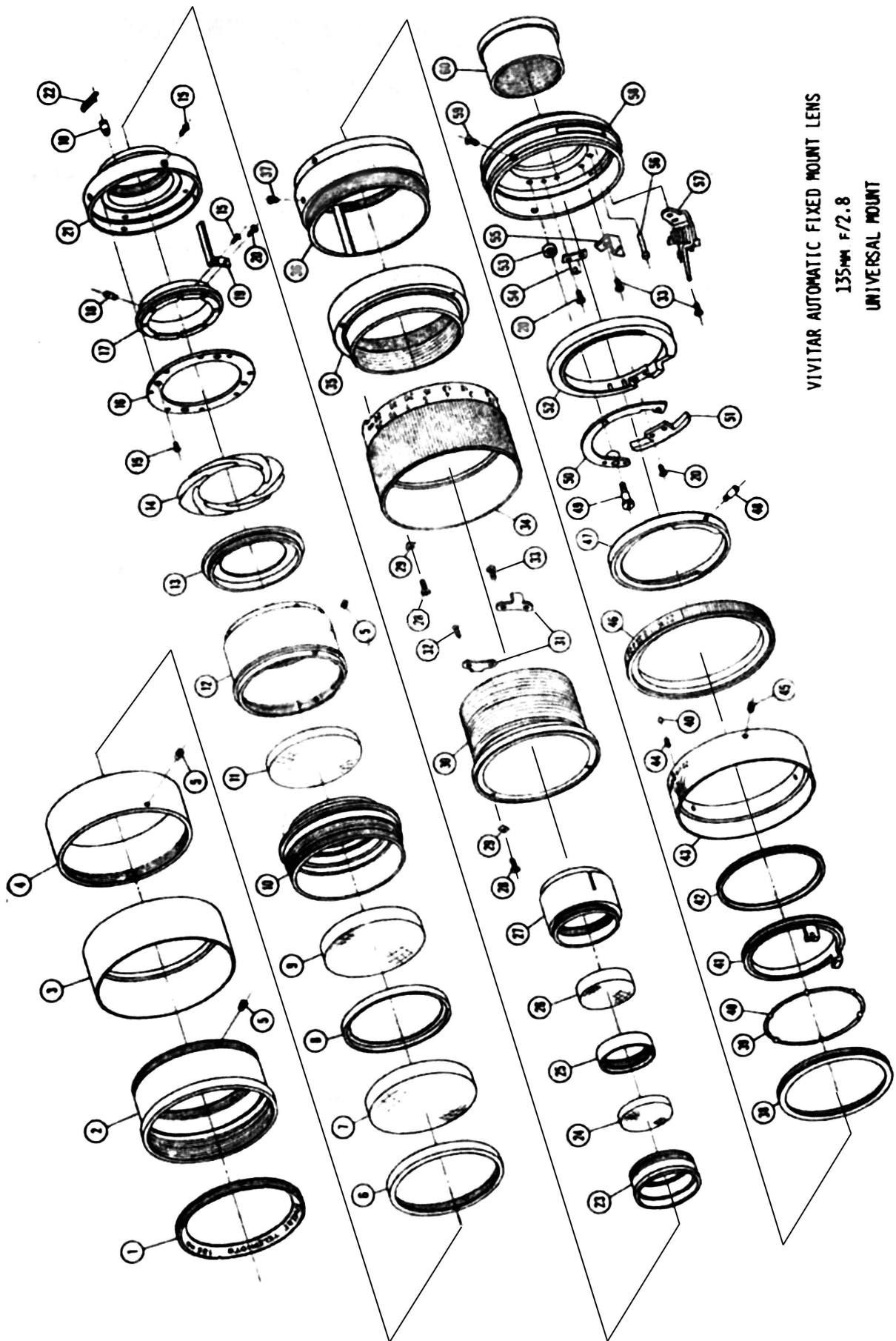
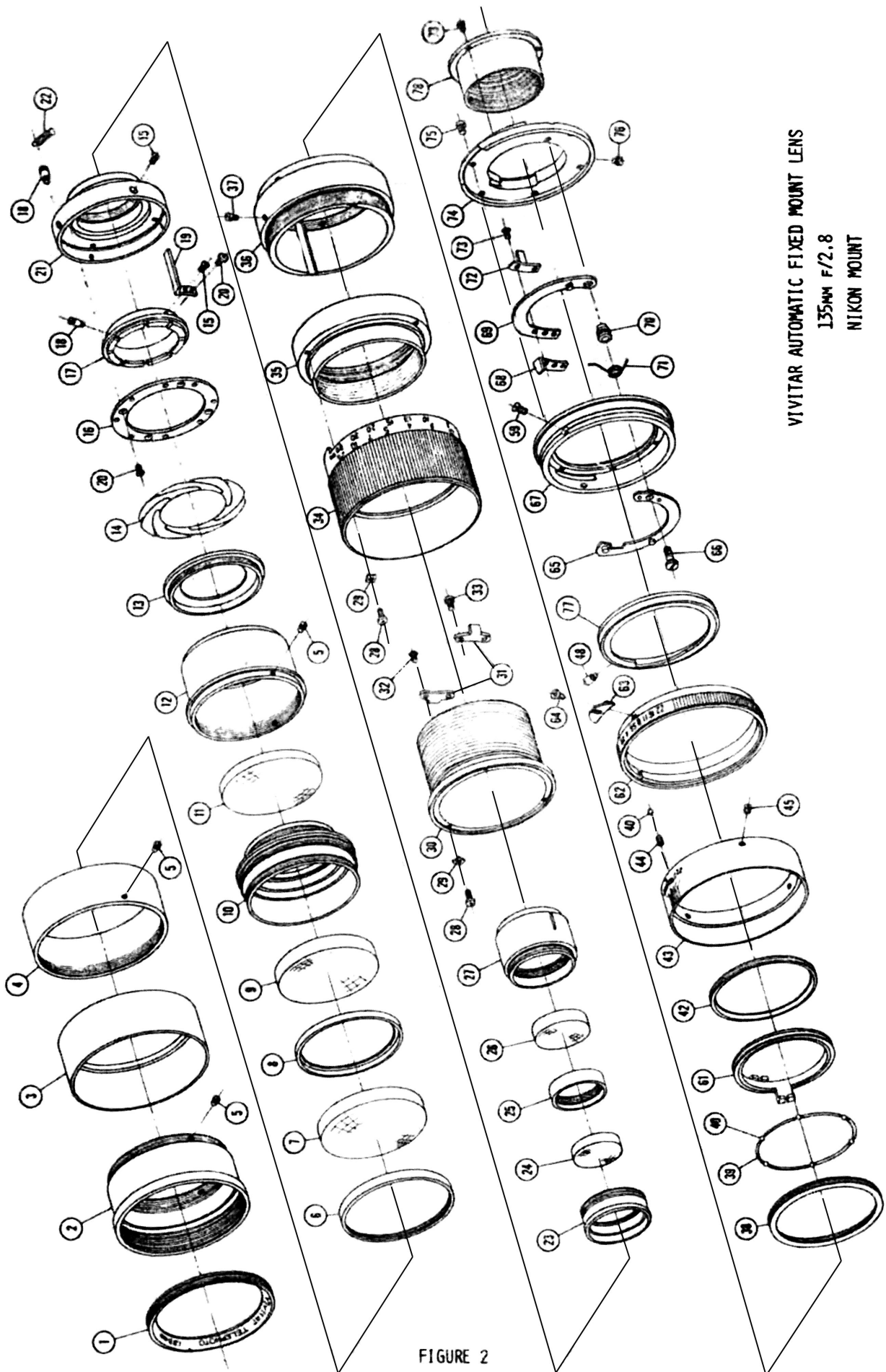

FIGURE 1

VIVITAR AUTOMATIC FIXED MOUNT LENS
135mm F/2.8
UNIVERSAL MOUNT



VIVITAR AUTOMATIC FIXED MOUNT LENS
135MM F/2.8
NIKON MOUNT

FIGURE 2

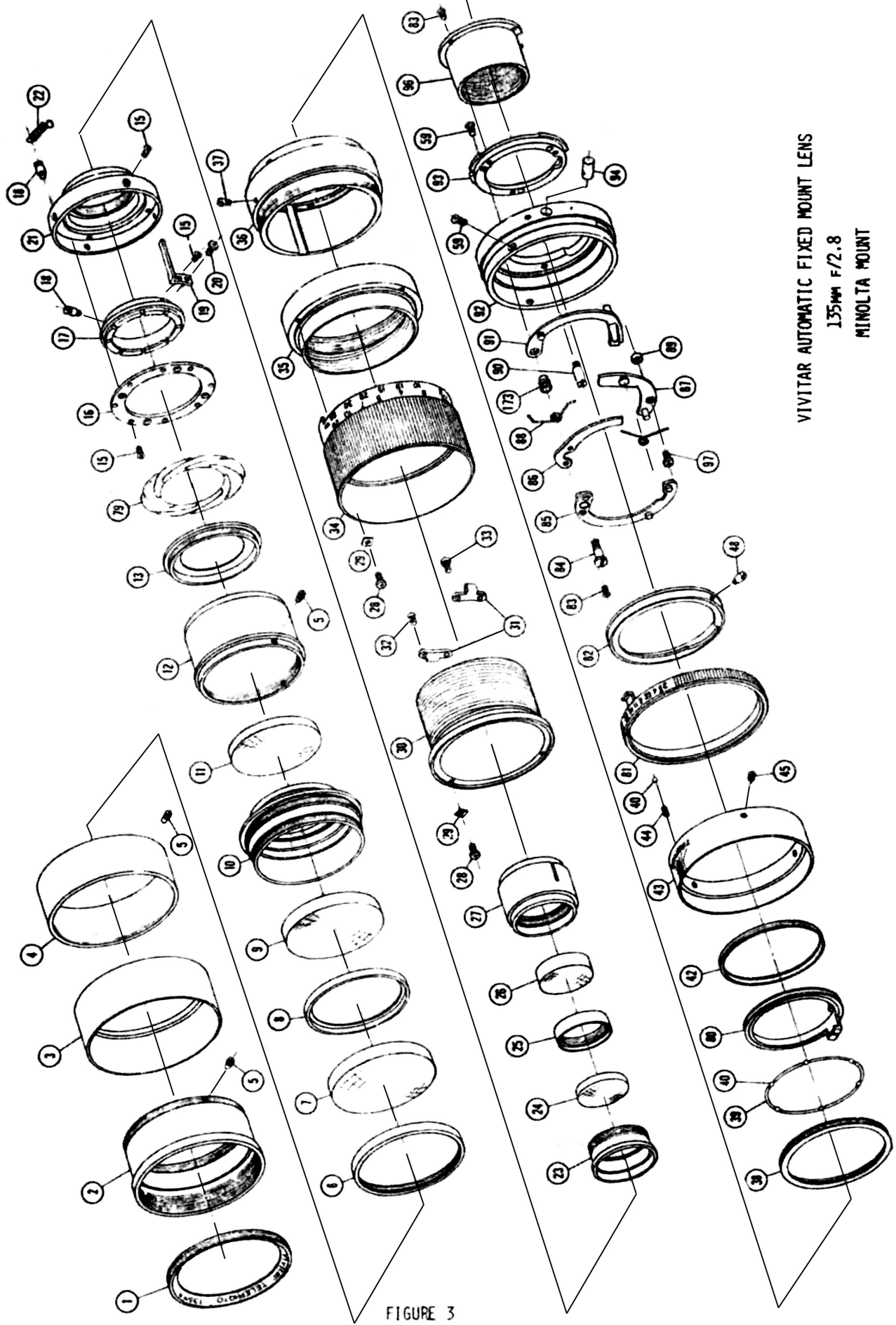
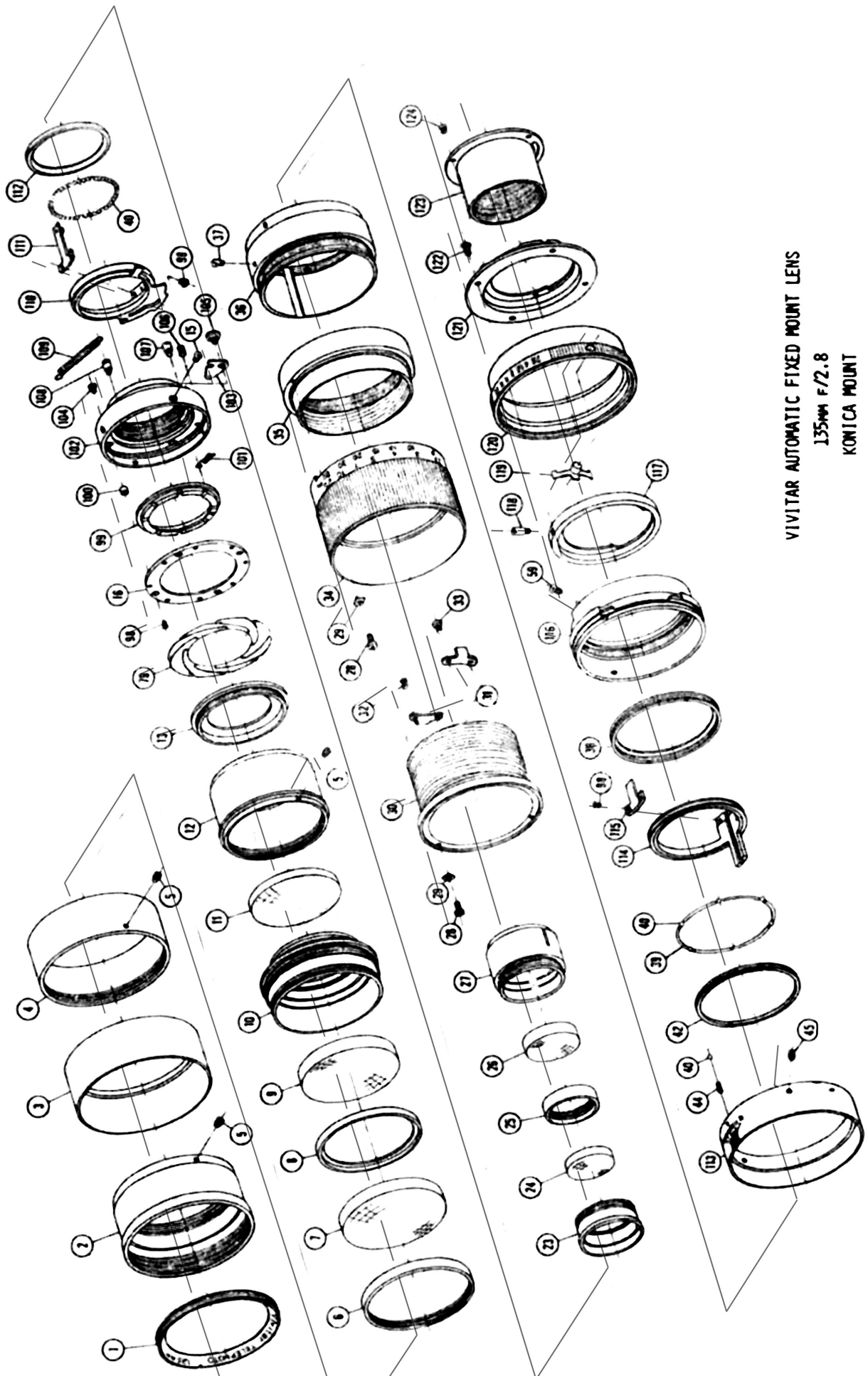

FIGURE 3

VIVITAR AUTOMATIC FIXED MOUNT LENS
135mm F/2.8
MINOLTA MOUNT



VIVITAR AUTOMATIC FIXED MOUNT LENS
135mm F/2.8
KONICA MOUNT

FIGURE 4

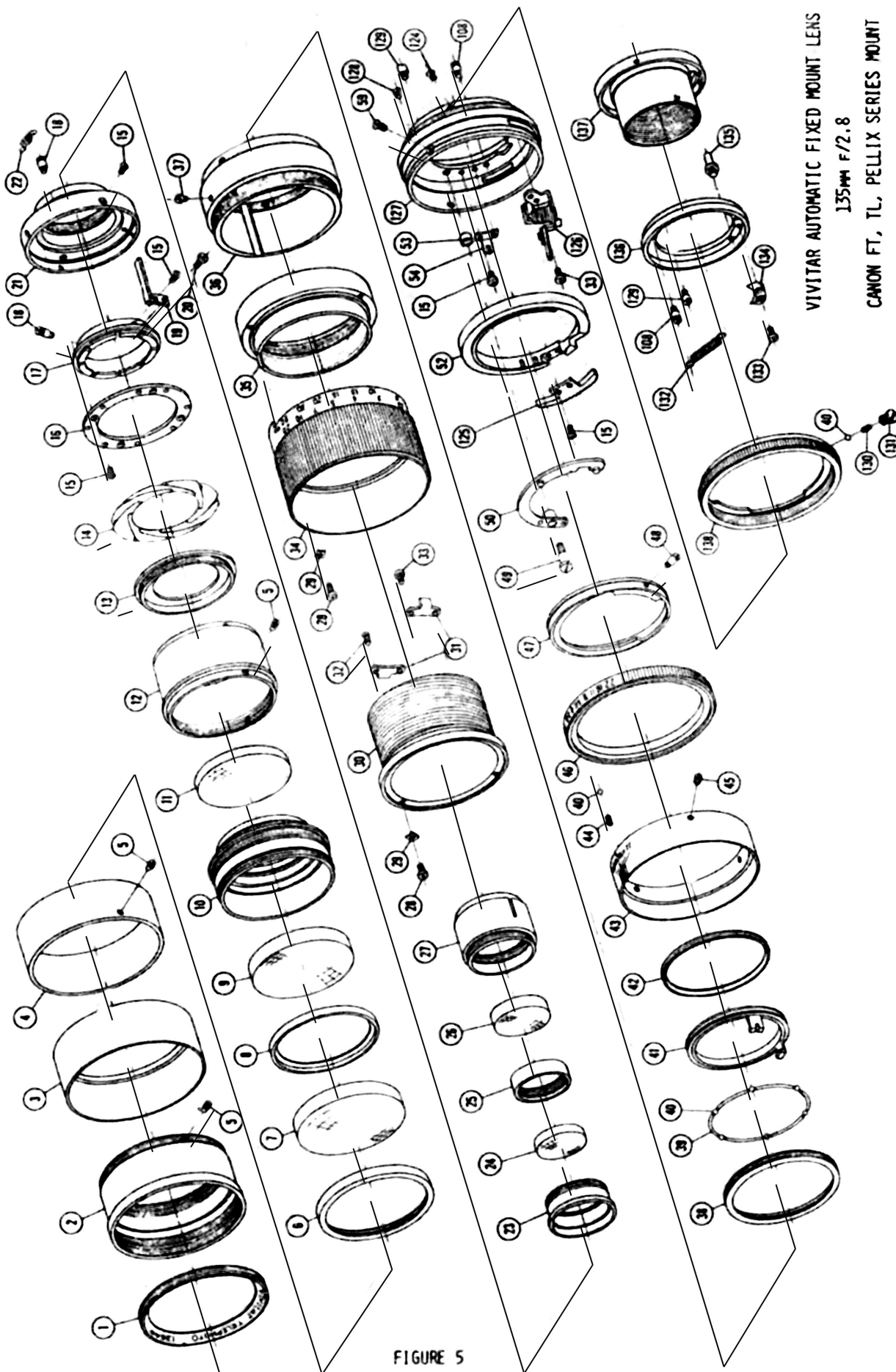

VIVITAR AUTOMATIC FIXED MOUNT LENS
135mm F/2.8
CANON FT, TL, PELLIX SERIES MOUNT

FIGURE 5

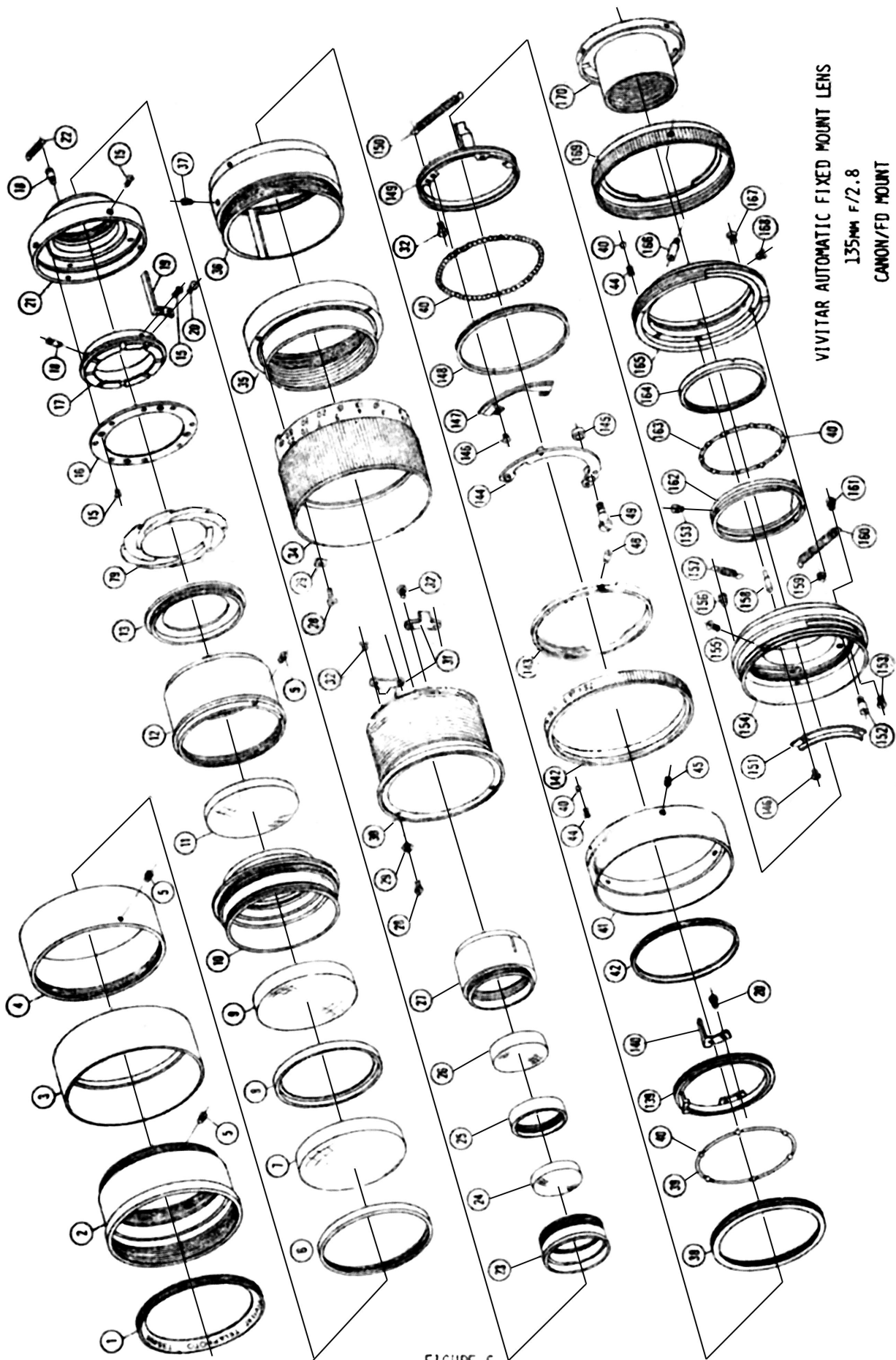

VIVITAR AUTOMATIC FIXED MOUNT LENS
135mm F/2.8
CANON/FD MOUNT

FIGURE 6

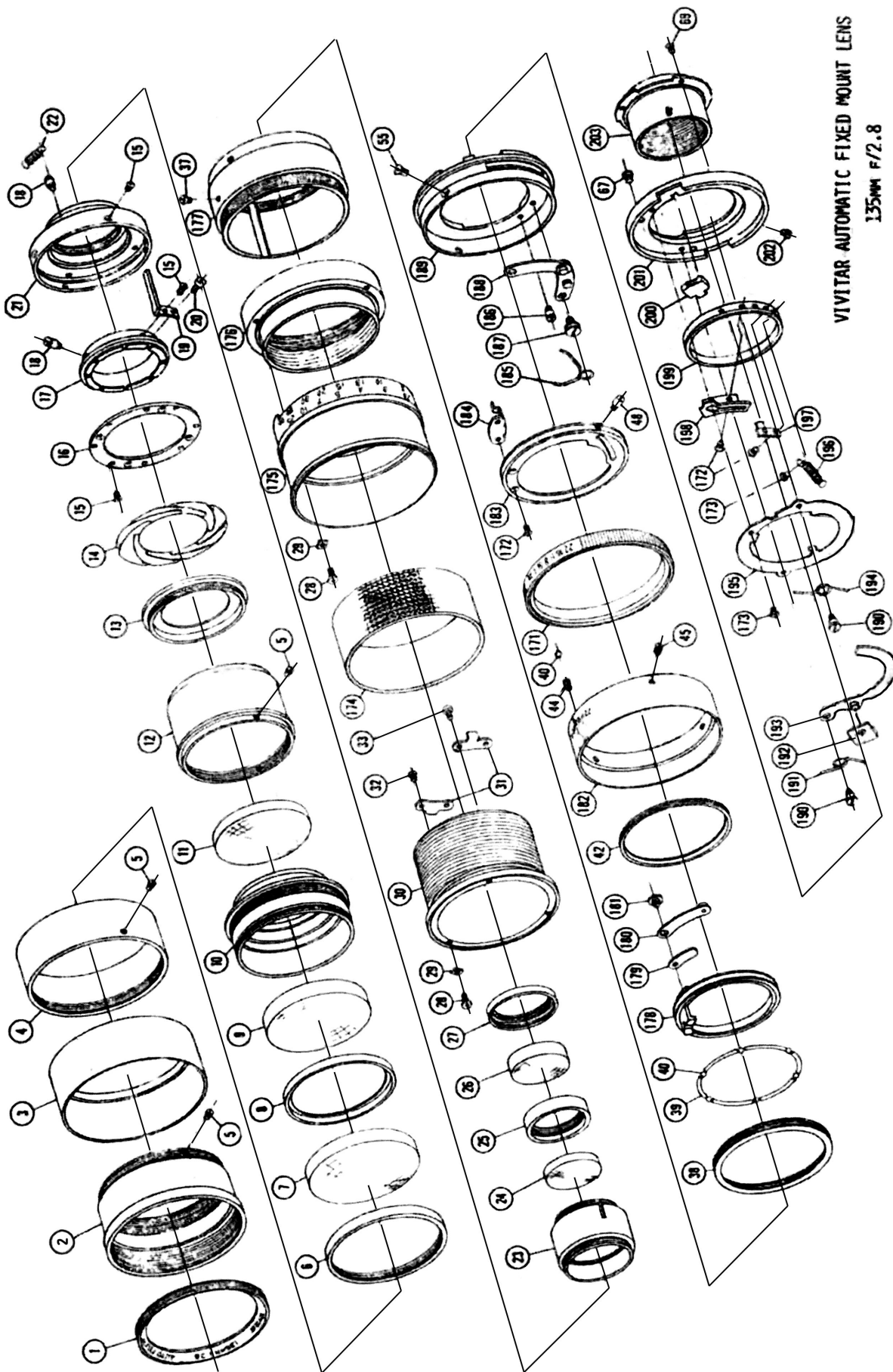

VIVITAR AUTOMATIC FIXED MOUNT LENS
135mm F/2.8
OLYMPUS MOUNT

FIGURE 7

PARTS LIST
VIVITAR AUTOMATIC FIXED MOUNT LENS

For Lenses Beginning
With Serial No. 28-----

135MM F/2.8

REFERENCE	DESCRIPTION	PART NUMBER	MOUNT & QUANTITY						O	C/FD
			U	N	M	K	C			
1	RING, NAME	3513223	1	1	1	1	1	1	1	1
2	HOUSING, FRONT	3513226	1	1	1	1	1	1	1	1
3	HOOD, LENS	3513227	1	1	1	1	1	1	1	1
4	RING, FRONT DECORATION	3513229	1	1	1	1	1	1	1	1
5	SETSCREW	3513580	7	7	7	7	7	7	7	7
6	HOLDER, 1st LENS ELEMENT	3513263	1	1	1	1	1	1	1	1
7	LENS ELEMENT, 1st	3513297	1	1	1	1	1	1	1	1
8	SPACER, 1st & 2nd LENS ELEMENT	3513272	1	1	1	1	1	1	1	1
9	LENS ELEMENT, 2nd	3513298	1	1	1	1	1	1	1	1
10	HOUSING, FRONT LENS GROUP	3513273	1	1	1	1	1	1	1	1
11	LENS ELEMENT, 3rd	3513299	1	1	1	1	1	1	1	1
12	LENS BODY	3513275	1	1	1	1	1	1	1	1
13	HOLDER, DIAPHRAGM BLADE	3513470	1	1	1	1	1	1	1	1
14	BLADE, DIAPHRAGM	3513581	8	8			8	8		
15	SCREW M1.4 x 2 SSN (+)	3513042	9	9	9	4	9	9	9	9
16	HOLE WASHER FOR DIAPHRAGM	3513499	1	1	1	1	1	1	1	1
17	RING, BLADE OPERATING	3513471	1	1	1	1	1	1	1	1
18	SCREW, DIAPHRAGM SPRING	3513574	2	2	2	2	2	2	2	2
19	ARM, BLADE OPERATING RING	3513293	1	1	1	1	1	1	1	1
20	SCREW	3513055	3	1	1	1	3	1	1	1
21	HOUSING, DIAPHRAGM	3513472	1	1	1		1	1	1	1
22	SPRING, DIAPHRAGM	3513043	1	1	1		1	1	1	1
23	HOLDER, 4th LENS ELEMENT	3513278	1	1	1	1	1	1	1	1
	HOLDER, 4th LENS ELEMENT	3515707							1	
24	LENS ELEMENT, 4th	3513300	1	1	1	1	1	1	1	1
25	SPACER, 4th & 5th LENS ELEME	3513279	1	1	1	1	1	1	1	1
26	LENS ELEMENT, 5th	3513433	1	1	1	1	1	1	1	1
27	HOUSING, REAR LENS GROUP	3513280	1	1	1	1	1			1
	HOUSING, REAR LENS GROUP	3515708							1	
28	SCREW	3513513	7	7	7	7	7	7	7	7
29	WASHER	3513286	7	7	7	7	7	7	7	7
30	HELICOID, FIRST INNER	3513282	1	1	1	1	1	1	1	1
31	GUIDE, HELICOID	3513027	2	2	2	2	2	2	2	2
32	SCREW	3513583	4	4	2	2	4	4	4	4
33	SCREW	3513028	5	2	2	2	4	4	4	4
34	RING, SCALE	3513281	1	1	1	1	1			1
35	HELICOID, MIDDLE	3513283	1	1	1	1	1			1
36	HELICOID, OUTER	3513284	1	1	1	1	1			1
37	SCREW	3513031	1	1	1	1	1	1	1	1
38	RING, BALL RACE	3513234	1	1	1	1	1	1	1	1
39	SPACER, BALL	3513036	6	6	6	6	6	6	6	6
40	BALL 1.5ø	3513041	7	7	7	70	8	7		122

PARTS LIST

VIVITAR AUTOMATIC FIXED MOUNT LENS

For Lenses Beginning
With Serial No. 28-----

135MM F/2.8

REFERENCE	DESCRIPTION	PART NUMBER	MOUNT & QUANTITY						
			U	N	M	K	C	O	C/FD
41	RING, OPERATION	3513285	1				1		
42	RING, BALL RETAINING	3513235	1	1	1	1	1	1	1
43	RING, DEPTH OF FIELD	3513286	1	1	1		1		
44	SPRING, DETENT	3513048	1	1	1	2	1	1	2
45	SETSCREW	3513039	3	3	3	3	3	3	3
46	RING, DIAPHRAGM	3513287	1				1		
47	RING, CAM	3513288	1				1		
48	SCREW, CAM OPERATION	3513066	1	1	1			1	1
49	SHAFT, CONTROL METAL	3513051	1				1		1
50	CONTROL METAL ASSEMBLY	3513052	1				1		
51	DIAPHRAGM LEVER, MANUAL	3513370	1						
52	DIAPHRAGM RING, MANUAL	3513289	1				1	1	
53	WASHER, CONTROL METAL SHAFT	3513053	1						
54	SPRING, DETENT	3513056	1						
55	PLATE, STOP	3513057	1						
56	PIN, DIAPHRAGM OPERATION	3513064	1						
57	OPERATION METAL ASSEMBLY	3513295	1						
58	HOUSING, MOUNT	3513290	1						
59	SCREW	3513347	3	3	6	3	3	3	3
60	RING, REAR COVER	3513291	1						
61	RING, OPERATION	3513434		1					
62	RING, DIAPHRAGM	3513435		1					
63	PLATE, METER COUPLING	3513576		1					
64	SCREW	3513080		1					
65	CONTROL METAL ASSEMBLY	3513294		1					
66	SHAFT, CONTROL METAL	3513530		1					
67	HOUSING, MOUNT	3513437		1					
68	OPERATION METAL I	3513533		1					
69	OPERATION METAL II ASSEMBLY	3513534		1					
70	WASHER, CONTROL METAL SHAFT	3513103		1					
71	SPRING, OPERATION METAL	3513531		1					
72	OPERATION METAL III	3513535		1					
73	SCREW	3513583		5					
74	NIKON MOUNT	3513536		1					
75	SCREW, MOUNT	3513093		5					
76	SCREW, FLAT	3513092		1					
77	RING, CAM	3513436		1					
78	RING, REAR COVER	3513438		1					
79	BLADE, DIAPHRAGM	3513584			8	8			8
80	RING, OPERATION	3513439			1				

PARTS LIST
VIVITAR AUTOMATIC FIXED MOUNT LENS
135MM F/2.8

For Lenses Beginning
With Serial No. 28-----

REFERENCE	DESCRIPTION	PART NUMBER	MOUNT & QUANTITY						
			U	N	M	K	C	O	C/FD
81	RING, DIAPHRAGM	3513440			1				
82	RING, CAM	3513441			1				
83	SCREW	3513094			5				
84	SHAFT, CONTROL METAL	3513099			1				
85	CONTROL METAL SET	3513100			1				
86	DIAPHRAGM METAL, MANUAL	3513544			1				
87	BASE, OPERATION METAL	3513545			1				
88	SPRING, OPERATION METAL	3513102			1				
89	WASHER, OPERATION METAL BASE	3513546			1				
90	SCREW, CONTROL METAL HOLDER	3513547			1				
91	OPERATION METAL SET	3513104			1				
92	FRAME, MINOLTA MOUNT	3513442			1				
93	BAYONET, MINOLTA MOUNT	3513523			1				
94	BUTTON, MANUAL DIAPHRAGM	3513444			1				
95	SPRING, BUTTON	3513543			1				
96	RING, REAR COVER	3513443			1				
97	SCREW, FLAT HEAD	3513585			1				
98	SCREW, FLAT HEAD	3513019						8	
99	RING, BLADE OPERATING	3513452						1	
100	NUT, ROUND	3513072						4	
101	SPRING, OPERATING RING	3513187						1	
102	HOUSING, DIAPHRAGM	3513453						1	
103	PLATE, SECTOR ASSEMBLY	3513070						1	
104	SCREW, FLAT	3513073						1	
105	SHAFT, SECTOR PLATE	3513071						1	
106	SCREW, BLADE OPERATING RING	3513185						1	
107	SCREW, CAM STOP	3513582						1	
108	SCREW, SMALL	3513552						1	1
109	SPRING, CAM OPERATING	3513397						1	
110	RING, CAM ASSEMBLY	3513454						1	
111	LEVER, CAM	3513461						1	
112	RING, BALL RETAINER	3513455						1	
113	RING, DEPTH OF FIELD	3513456						1	
114	RING, OPERATION	3513457						1	
115	LEVER, OPERATION	3513117						1	
116	FRAME, KONICA MOUNT	3513458						1	
117	RING, STOP	3513558						1	
118	SCREW, STOP RING	3513123						1	
119	LOCK, BUTTON ASSEMBLY	3513120						1	
120	RING, DIAPHRAGM	3513459						1	

PARTS LIST
VIVITAR AUTOMATIC FIXED MOUNT LENS

For Lenses Beginning
With Serial No. 28-----

135MM F/2.8

REFERENCE	DESCRIPTION	PART NUMBER	MOUNT & QUANTITY						
			U	N	M	K	C	O	C/FD
121	KONICA MOUNT	3513124					1		
122	SCREW	3513125					4		
123	RING, F/SETTING	3513460					1		
124	SCREW	3513189					3	3	
125	DIAPHRAGM LEVER, MANUAL	3513450					1		
126	OPERATION METAL ASSEMBLY	3513451					1		
127	HOUSING, CANON MOUNT	3513446					1		
128	SCREW, FLAT	3513092					1		
129	SCREW, CAM OPERATION	3513500					3		
130	SPRING, DETENT	3513575					1		
131	SCREW, DETENT TUBE	3513571					1		
132	SPRING, DIAPHRAGM OPERATION	3513573					1		
133	SCREW, PAN HEAD	3513513					2		
134	CAM, DIAPHRAGM OPERATION	3513570					1		
135	PIN, DIAPHRAGM OPERATING	3513572					1		
136	RING, OPERATION	3513448					1		
137	RING, REAR COVER	3513449					1		
138	RING, LOCK	3513447					1		
139	RING, ACTUATOR	3513275							1
140	ARM, ACTUATOR RING	3513130							1
141	RING, DEPTH OF FIELD	3515711							1
142	RING, DIAPHRAGM	3515712							1
143	RING, AE SETTING	3513256							1
144	ARM, DIAPHRAGM ACTUATING	3513134							1
145	SPACER	3513053							1
146	SCREW, M1.4 x 2.0	3513019							2
147	PLATE, CAM	3515717							1
148	RING, BALL RETAINER	3513037							1
149	RING, F/SETTING	3513258							1
150	SPRING	3513151							1
151	GUIDE, SPRING	3513138							1
152	POST, SCREW	3515165							1
153	POST, SPRING	3513152							1
154	FRAME, MOUNT	3515724							1
155	SCREW, M1.7 x 4.0	3513347							3
156	POST, SPRING	3513090							1
157	SPRING	3513140							1
158	PIN, AE DISCRIMINATION	3513156							1
159	POST, SPRING	3513149							1
160	SPRING	3513150							1
161	POST, SPRING	3513090							1

PARTS LIST
VIVITAR AUTOMATIC FIXED MOUNT LENS

For Lenses Beginning
With Serial No. 28-----

135MM F/2.8

REFERENCE	DESCRIPTION	PART NUMBER	MOUNT & QUANTITY						
			U	N	M	K	C	O	C/FD
162	RING, MANUAL	3513141							1
163	SPACER, BALL	3513148							10
164	RING, BALL RETAINER	3513567							1
165	MOUNT, CANON	3513144							1
166	SCREW, SIGNAL	3513430							1
167	SCREW, M1.7 x 4.0	3515157							4
168	SCREW, M1.4 x 2.2	3513189							1
169	RING, MOUNT LOCKING	3513429							1
170	RING, REAR	3515740							1
171	RING, DIAPHRAGM	3515741						1	
172	SCREW, FLATHEAD M1.4 x 2.0	3513161						2	
173	SCREW	3513344		1				2	
174	GRIP	3513414						1	
175	RING, FOCUSING	3515745						1	
176	HELICOID, MIDDLE	3513283						1	
177	HELICOID, OUTER	3513284						1	
178	RING, ACTUATOR	3515748						1	
179	WASHER, SPACER	3513155						1	
180	LINK	3513158						1	
181	SCREW, SHOULDER	3513071						1	
182	RING, DEPTH OF FIELD	3515752						1	
183	RING, CAM	3515753						1	
184	LEVER, DIAPHRAGM	3513165						1	
185	SPRING	3513164						1	
186	POST, SPRING	3513166						1	
187	SCREW, SHOULDER	3513163						1	
188	LINK ASSEMBLY	3513167						1	
189	FRAME, MOUNT	3515759						1	
190	SCREW, SHOULDER	3513170						1	
191	SPRING	3513171						1	
192	BUTTON, MANUAL	3513169						1	
193	LEVER, MANUAL	3513172						1	
194	SPRING	3513174						1	
195	RING, ACTUATOR	3513183						1	
196	SPRING	3513176						1	
197	PLATE, ANGLE	3513182						1	
198	PLATE, CAM	3513184						1	
199	RING, PLATE	3513177						1	
200	BUTTON, MOUNT LOCK	3513173						1	
201	MOUNT, OLYMPUS	3513178						1	
202	SCREW, STOP	3513181						1	
203	RING, SHADE	3515773						1	



Recreated from a poor photocopy by:

Prepared by:
Service Engineering Div.

Vivitar Corporation
Corporate Offices:
1630 Stewart Street, Santa Monica, Ca 90406

Printed in U.S.A.

Vivitar is an International Trademark of Vivitar Corporation